

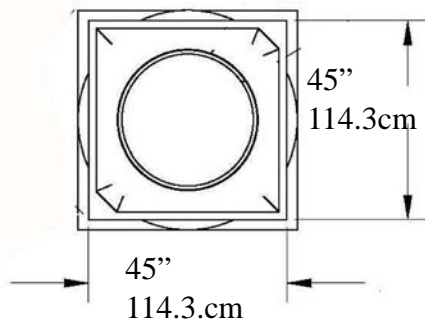

Tuscan Tapered Column

IPTUS2036S-TCTB Fiberglass

Tuscan Capital ArchPolymert™



Cap 10-1/2" (26.6cm)=>

Top of Shaft

Outside Diameter

30"

76.2cm

<=

Total
Height

Tuscan Base ArchPolymert™

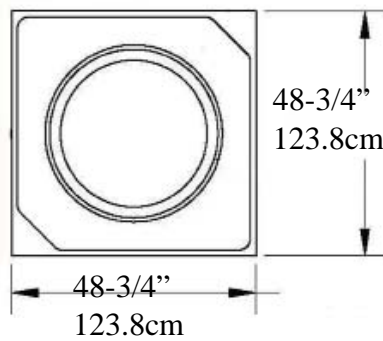

Bottom of Column

Outside Diameter

36"

91.4cm

20 Feet
6.096
meter

Imperial Productions®

Optional Cuts

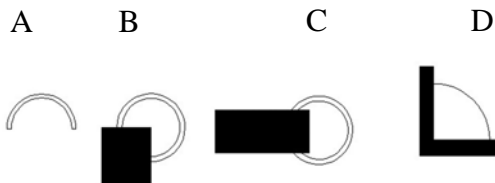

A= Half column

B = 3/4 Outside Corner

C = Wall Cover Engaged

D = 1/4 Column Inside Corner

E = Engaged any percentage

Taper Ends
from Bottom
approximately
47"

119.3 cm

Base & Plinth

20-1/8" (51.1cm)

=>

=>

<=

Weight Shaft 737 lb (334.3 Kg)

Centered Load to 20,000lbs (9.07m tons)

- * assembly required, drawing not to scale Loads must be Centered on the Shaft
- * Sold as a building Component - Intergration Hardware by others
- * For Load Application check with your structural engineer for suitability in your local area
- * All specifications subject to change without notice, Final products & Measurements may vary from this brochure E/OE



Imperial Productions®

Imperial Productions & Distribution Inc

email sales@imperialproductions.com copyright 2016 MRDCI All Rights Reserved

1-800-399-7585 +1-416-264-6096

SEP-25



Custom Request (Download & Fill-in)

sales@imperialproductions.com IPTUS2036S-TCTB

Name _____

Contact: _____

Phone # _____

Email: _____

Address _____
_____ ZIP/PC _____

MATERIAL SELECTION

A) Maple B) Red Oak C) Alder D) Walnut E) Cherry F) White Oak
of Units Each _____ Species _____

Fiberglass A Load Bearing Composite Interior/Exterior
of Each _____

VALUE ADDED FINISHES

Factory Paint Color Code _____ Finish _____

Metal Coated: Type: _____

* Possible Limitations due to Quantity Requested and/or Application



Imperial Productions®

1-800-399-7585

Imperial Productions & Distribution Inc.

email sales@imperialproductions.com copyright 2016 MRDCI All Rights Reserved