

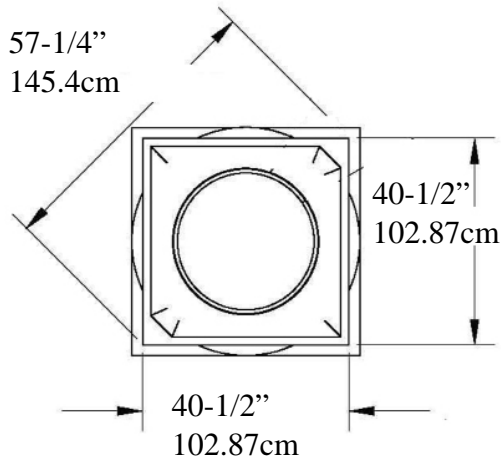

Tuscan Non-Tapered Smooth Column

IPTUS1430SNT-TCTB FRP-PolyComp™

Tuscan Capital ArchPolymert™



16-1/2" (41.9cm)

Optional Astragal=>

Top of Shaft
Minimum
Inside Diameter
28" (71.12cm)

Outside Diameter
30" (76.2cm)

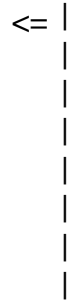

Total
Height

14 Feet
4.267
metre

Tuscan Base EconPolymert™

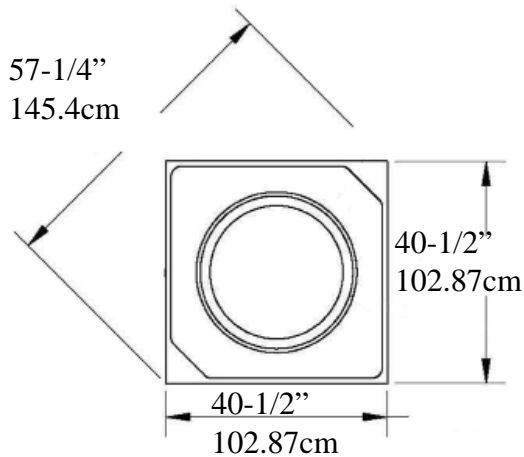

Bottom of Column
Outside Diameter
30"
76.2cm

Imperial
Productions®

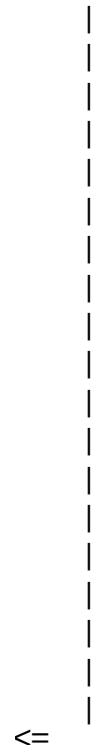

Optional Cuts

A B C D



A= Half column

B = 3/4 Outside Corner

C = Wall Cover Engaged

D = 1/4 Column Inside Corner

E = Engaged any percentage

Base & Plinth =>
16-1/2" (41.9cm)

=>

Shaft weight call
Center Loads to 20,000lbs

=<

* assembly required, drawing not to scale Loads must be Centered on the Shaft

* Sold as a building Component - Intergration Hardware by others

* For Load Application check with your structural engineer for suitability in your local area

* All specifications subject to change without notice, Final products & Measurements may vary from this brochure E/OE



Imperial Productions®

Imperial Productions & Distribution Inc

email sales@imperialproductions.com

1-800-399-7585 +1-416-264-6096

copyright 2016 MRDCI All Rights Reserved

SEP-25



Custom Request (Download & Fill-in)

sales@imperialproductions.com IPTUS1430SNT-TCTB

Name _____

Contact: _____

Phone # _____

Email: _____

Address _____
_____ ZIP/PC _____

FRP-PolyComp™ A Composite Gypsum, Fiberglass, Marble Chips, Prime & Paint by others

(Interior/Exterior)

of Whole Units _____ # of Split Units _____

Type of Split enter Letter _____

Optional Cuts

A

B

C

D



A= Half column

B = 3/4 Outside Corner

C = Wall Cover Engaged

D = 1/4 Column Inside Corner

E = Engaged any percentage

* Possible Limitations due to Quantity Requested and/or Application



Imperial Productions®

1-800-399-7585 +1-416-264-6096

Imperial Productions & Distribution Inc.

email sales@imperialproductions.com copyright 2016 MRDCI All Rights Reserved