

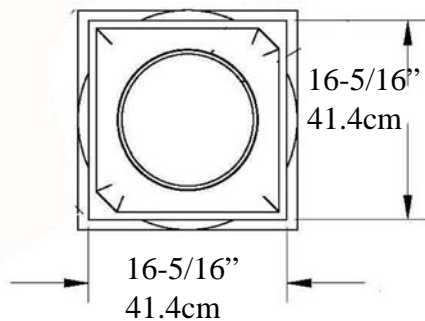

Tuscan Tapered Column

IPTUS1414S-TCTB Fiberglass

Tuscan Capital EconPolymert™



Cap 4-1/4" (10.7cm)=>

Top of Shaft
Outside Diameter
11-1/2"
29.2cm

<=

Total
Height

14 Feet
4.267
meter

Tuscan Base EconPolymert™

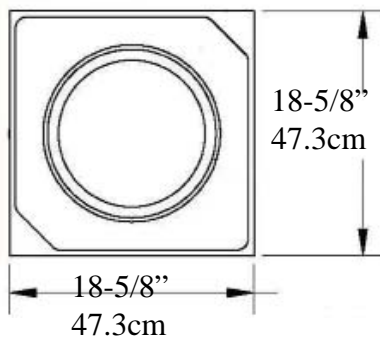

Taper Ends
from Bottom
approximately
39"
99cm

Imperial
Productions®

Bottom of Column
Outside Diameter
13-5/8"
34.6cm

Optional Cuts

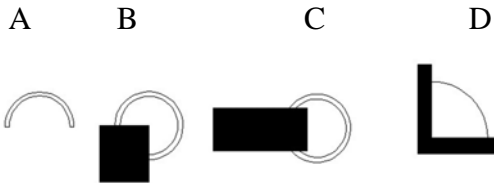

- A= Half column
- B = 3/4 Outside Corner
- C = Wall Cover Engaged
- D = 1/4 Column Inside Corner
- E = Engaged any percentage

Base & Plinth
7-3/4" (19.6cm)

=>

=>

<=

Weight Shaft 199 lb (90.26 Kg)
Centered Load to 20,000lbs (9.07m tons)

- * assembly required, drawing not to scale Loads must be Centered on the Shaft
- * Sold as a building Component - Intergration Hardware by others
- * For Load Application check with your structural engineer for suitability in your local area
- * All specifications subject to change without notice, Final products & Measurements may vary from this brochure E/OE



Imperial Productions®

Imperial Productions & Distribution Inc

email sales@imperialproductions.com copyright 2016 MRDCI All Rights Reserved

1-800-399-7585 +1-416-264-6096

SEP-25



Custom Request (Download & Fill-in)

sales@imperialproductions.com IPTUS1414S-TCTB

Name _____

Contact: _____

Phone # _____

Email: _____

Address _____
_____ ZIP/PC _____

Fiberglass Prime & Paint by others

(Interior/Exterior)

of Whole Units _____ # of Split Units _____

Type of Split enter Letter _____

Optional Cuts

A

B

C

D



A= Half column

B = 3/4 Outside Corner

C = Wall Cover Engaged

D = 1/4 Column Inside Corner

E = Engaged any percentage

* Possible Limitations due to Quantity Requested and/or Application



Imperial Productions®

1-800-399-7585 +1-416-264-6096

Imperial Productions & Distribution Inc.

email sales@imperialproductions.com copyright 2016 MRDCI All Rights Reserved