

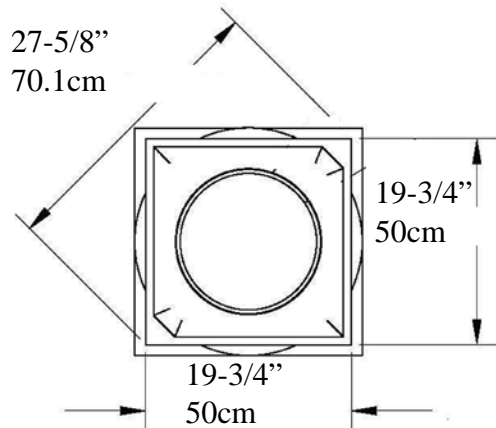

Tuscan Non Tapered Column

IPTUS1216SNT-TCTB Fiberglass

Tuscan Capital ArchPolymert™



Cap 8-1/4" (20.9cm)

Optional Astragal=>

Top of Shaft
Minimum
Inside Diameter
13" (33cm)

Outside Diameter
15-1/2" (39.3cm)

Tuscan Base ArchPolymert™

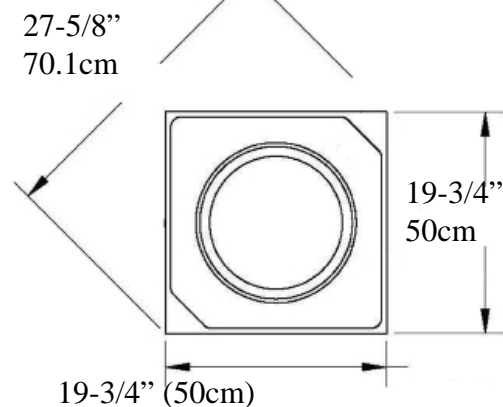

Bottom of Column
Outside Diameter
15-1/2" (39.3cm)

Optional Cuts

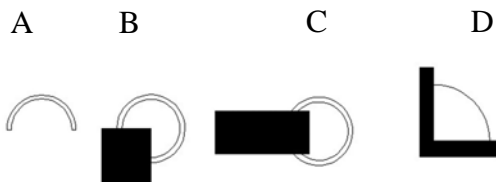

A = Half column

B = 3/4 Outside Corner

C = Wall Cover Engaged

D = 1/4 Column Inside Corner

E = Engaged any percentage

Base & Plinth =>
8-1/4" (20.9cm)

=>

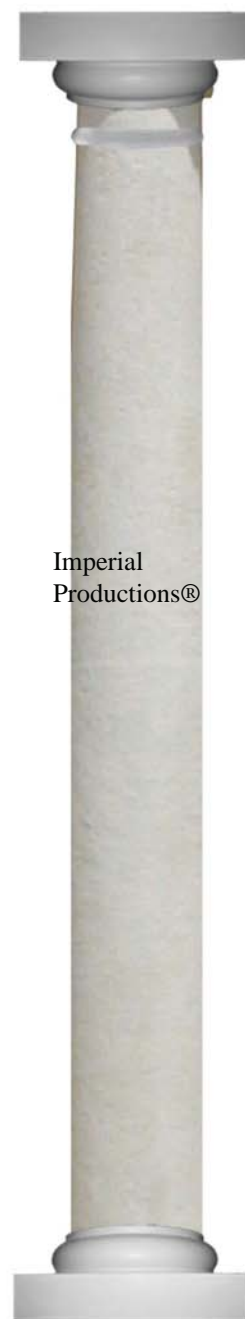

<=

Total
Height
12 Feet
144"

3.657
meter

<=

Shaft weight 192 lbs (87kg)
Center Loads to 20,000lbs (9.07m tons)

* *assembly required, drawing not to scale*

* *For Load Application check with your structural engineer for suitability in your local area*

* All specifications subject to change without notice, Final products & Measurements may vary from this brochure



Imperial Productions®

Imperial Productions & Distribution Inc.

email sales@imperialproductions.com

1-800-399-7585 +1-416-264-6096

copyright 2016 MRDCI All Rights Reserved

NOV-25



Custom Request (Download & Fill-in)

sales@imperialproductions.com IPTUS1216SNT-TCTB

Name _____

Contact: _____

Phone # _____

Email: _____

Bill to Address _____
_____ ZIP/PC _____

Ship to Address _____
_____ ZIP/PC _____

All deliveries shipped with insurance

Specify the type of Delivery Required Enter Letter => _____

a) Residential

b) Residential with tailgate

c) Commercial with Loading Dock

d) Commercial Curbside Delivery

A) Whole How Many _____

B) Split for Post Wrap How Many _____

To Wrap Round Post Size _____ Square Post Size _____

How are they split _____

C) Split for Pilaster How Many _____

* Possible Limitations due to Quantity Requested and/or Application



Imperial Productions®

Imperial Productions & Distribution Inc.

email sales@imperialproductions.com copyright 2016 MRDCI All Rights Reserved

1-800-399-7585 +1-416-264-6096