



Tuscan Tapered Column

IPTUS1214S-TCTB FRP-PolyComp™

Tuscan Capital EconPolymer™

Cap 4-1/4" (10.7cm)=>

Diagonal
23"
58.4cm

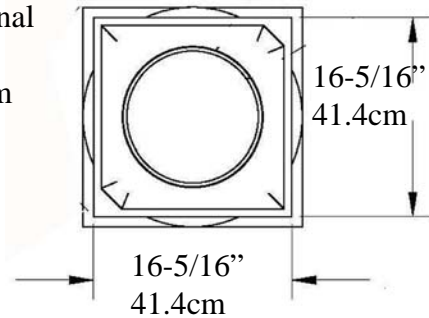

Top of Shaft
Outside Diameter
11-1/2"
29.2cm

<=

Total
Height

12 Feet
(144")

3.65 meter

Tuscan Base EconPolymer™

Diagonal
26-5/16"
66.8cm

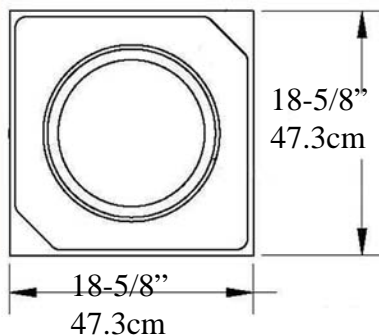

Bottom of Column
Outside Diameter
13-5/8"
34.6cm

Imperial Productions®

Optional Cuts

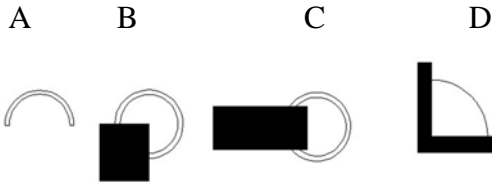

Taper Ends
from Bottom
approximately
48"
1.21 meters

A= Half column

B = 3/4 Outside Corner

C = Wall Cover Engaged

D = 1/4 Column Inside Corner

E = Engaged any percentage

Torus & Plinth
7-3/4" (19.6cm)

=>

=>

<=

Weight Shaft 184 lb (83.4 Kg)
Load O/c to 20,000lbs (9.07m tons)

* **assembly required, drawing not to scale**

* *For Load Application check with your structural engineer for suitability in your local area*

* All specifications subject to change without notice, Final products & Measurements may vary from this brochure



Imperial Productions®

1-800-399-7585

Imperial Productions & Distribution Inc.

email sales@imperialproductions.com copyright 2016 MRDCI All Rights Reserved

SEP-24



Custom Request (Download & Fill-in)

sales@imperialproductions.com IPTUS1214S-TCTB

Name _____

Contact: _____

Phone # _____

Email: _____

Bill to Address _____
_____ ZIP/PC _____

Ship to Address _____
_____ ZIP/PC _____

All deliveries shipped with insurance

Specify the type of Delivery Required Enter Letter => _____

a) Residential

b) Residential with tailgate

c) Commercial with Loading Dock

d) Commercial Curbside Delivery

A) Whole How Many _____

B) Split for Post Wrap How Many _____

To Wrap Round Post Size _____ Square Post Size _____

How are they split _____

C) Split for Pilaster How Many _____

* Possible Limitations due to Quantity Requested and/or Application



Imperial Productions®

1-800-399-7585 +1-416-264-6096

Imperial Productions & Distribution Inc.

email sales@imperialproductions.com copyright 2016 MRDCI All Rights Reserved