



Tuscan Tapered Column

IPTUS1212S-TCTB

FRP-PolyComp™

Tuscan Capital EconPolymer™

Diagonal
18-3/4"
47.6cm

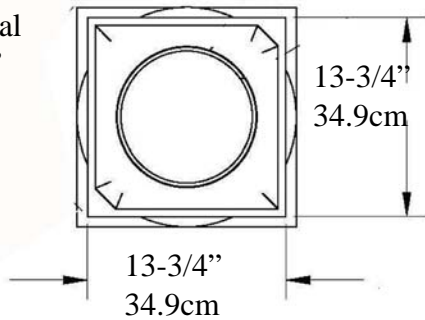

Cap 4" (10cm)=>

Top of Shaft
Outside Diameter
9-1/4" (24.4cm)

Minimum
Inside Diameter
8" (20.3cm)

Tuscan Base EconPolymer™

Diagonal
23-1/4"
59cm

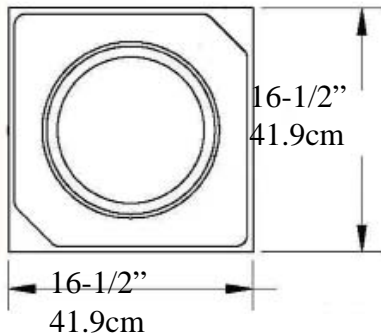

Taper Ends
from Bottom
40"
101.6cm

<=

Total
Height

10 Feet
(120")

3.04 meter

Imperial Productions®

Optional Cuts

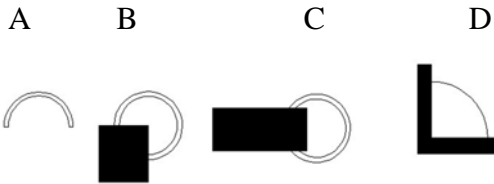

A= Half column

B = 3/4 Outside Corner

C = Wall Cover Engaged

D = 1/4 Column Inside Corner

E = Engaged any percentage

Bottom of Column
Outside Diameter
11-5/8"
29.5cm

Base & Plinth
6" (15.2cm)

=>

=>

<=

Weight 132 lb (59.8 Kg)

Load o/c to 18,000lbs (8.16m tons)

* *assembly required, drawing not to scale*

* *For Load Application check with your structural engineer for suitability in your local area*

* All specifications subject to change without notice, Final products & Measurements may vary from this brochure



Imperial Productions®

1-800-399-7585 +1-416-264-6096

Imperial Productions & Distribution Inc.

email sales@imperialproductions.com copyright 2016 MRDCI All Rights Reserved

SEP-24



Custom Request (Download & Fill-in)

sales@imperialproductions.com IPTUS1212S-TCTB

Name _____

Contact: _____

Phone # _____

Email: _____

Bill to Address _____
_____ ZIP/PC _____

Ship to Address _____
_____ ZIP/PC _____

All deliveries shipped with insurance

Specify the type of Delivery Required Enter Letter => _____

a) Residential

b) Residential with tailgate

c) Commercial with Loading Dock

d) Commercial Curbside Delivery

A) Whole How Many _____

B) Split for Post Wrap How Many _____

To Wrap Round Post Size _____ Square Post Size _____

How are they split _____

C) Split for Pilaster How Many _____

* Possible Limitations due to Quantity Requested and/or Application



Imperial Productions®

Imperial Productions & Distribution Inc.

email sales@imperialproductions.com copyright 2016 MRDCI All Rights Reserved

1-800-399-7585 +1-416-264-6096