

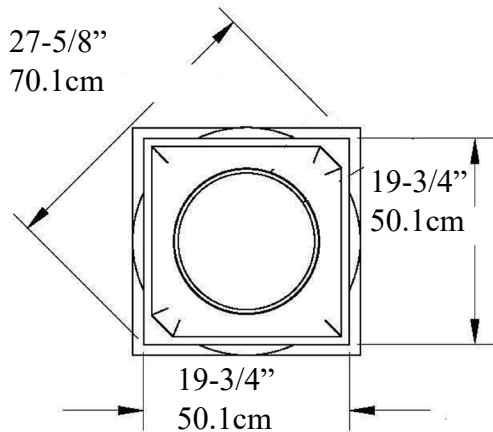

Tuscan Column

IPTUS1016SNT-TCTB Fiberglass

Tuscan Capital ArchPolymert™



Cap 8-1/4" (20.9cm)

Optional Astragal=>

Top of Shaft
Minimum
Inside Diameter
13" (33cm)

Outside Diameter
15-1/2" (39.3cm)

Tuscan Base ArchPolymert™

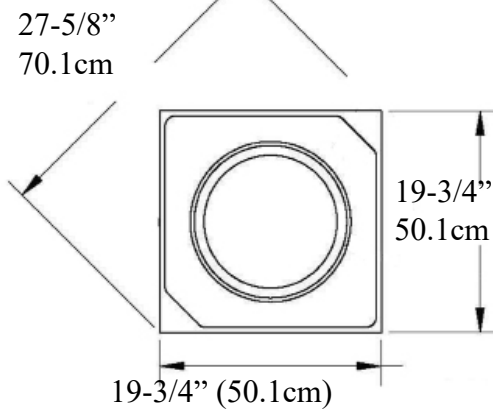

Bottom of Column
Outside Diameter
15-1/2" (39.3cm)

Optional Cuts

A B C D

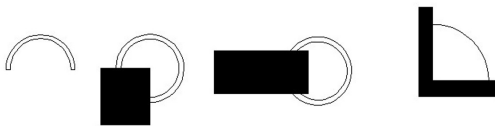

A= Half column

B = 3/4 Outside Corner

C = Wall Cover Engaged

D = 1/4 Column Inside Corner

E = Engaged any percentage

Base & Plinth =>
8-1/4" (20.9cm)

Shaft weight 160 lbs (72.5kg)
Center Loads to 20,000lbs (9.07m tons)

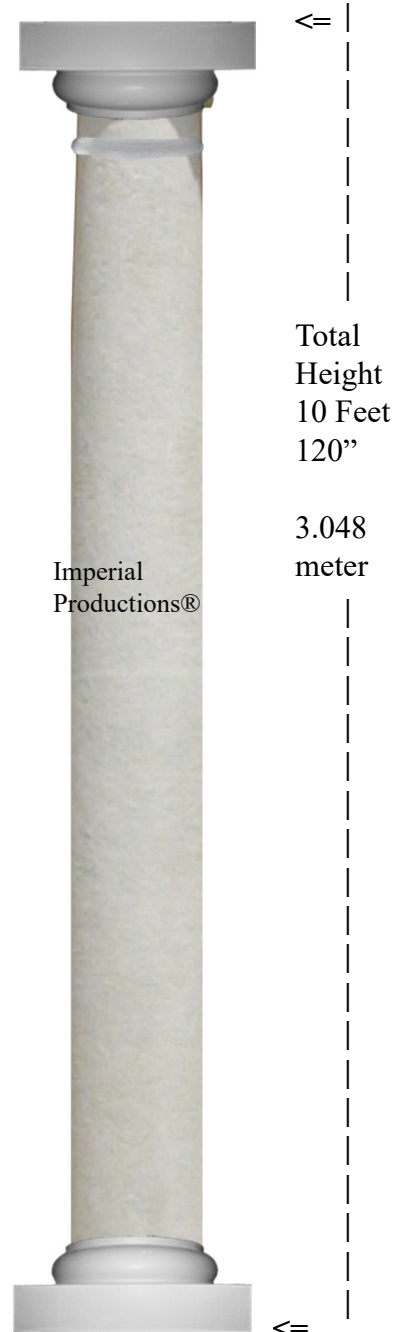

- * assembly required, drawing not to scale Loads must be Centered on the Shaft
- * Sold as a building Component - Intergration Hardware by others
- * For Load Application check with your structural engineer for suitability in your local area
- * All specifications subject to change without notice, Final products & Measurements may vary from this brochure E/OE



Imperial Productions®

1-800-399-7585 +1-416-264-6096

Imperial Productions & Distribution Inc

email sales@imperialproductions.com copyright 2016 MRDCI All Rights Reserved

SEP-25



Custom Request (Download & Fill-in)

sales@imperialproductions.com IPTUS1016SNT-TCTB

Name _____

Contact: _____

Phone # _____

Email: _____

Address _____
_____ ZIP/PC _____

Fiberglass

(Interior/Exterior)

of Whole Units _____ # of Split Units _____

Type of Split enter Letter _____

Optional Cuts

A

B

C

D



A= Half column

B = 3/4 Outside Corner

C = Wall Cover Engaged

D = 1/4 Column Inside Corner

E = Engaged any percentage

* Possible Limitations due to Quantity Requested and/or Application



Imperial Productions®

Imperial Productions & Distribution Inc.

email sales@imperialproductions.com copyright 2016 MRDCI All Rights Reserved

1-800-399-7585 +1-416-264-6096