



Tuscan Tapered Smooth Column

IPTUS0914S-TCTB FRP-PolyComp™

Tuscan Capital EconPolymertm

Diagonal
23"
58.4cm

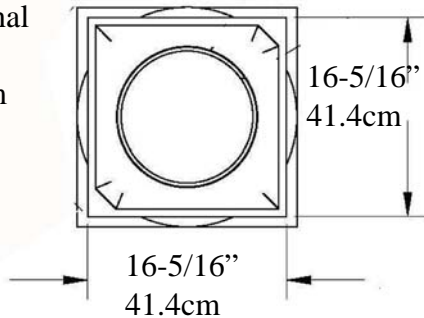

Cap 4-1/4" (10.7cm)=>

Top of Shaft

Outside Diameter
11-1/2"
29.2cm

Tuscan Base EconPolymertm

Diagonal
26-5/16"
66.8cm

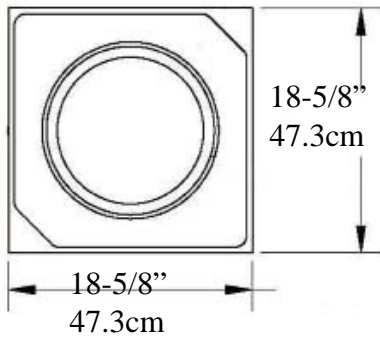

Bottom of Column
Outside Diameter
13-5/8"
34.6cm

Taper Ends
from Bottom
approximately
12"
30.48cm

Optional Cuts

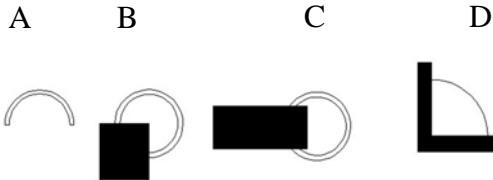

A= Half column

B = 3/4 Outside Corner

C = Wall Cover Engaged

D = 1/4 Column Inside Corner

E = Engaged any percentage

Base & Plinth
7-3/4" (19.6cm)



<=

Total
Height

9 Feet
(108")

2.74 metre

<=

Weight Shaft 158 lb (71.6 Kg)
Centered Load to 20,000lbs (9.07m tons)

* **assembly required, drawing not to scale**

* *For Load Application check with your structural engineer for suitability in your local area*

* All specifications subject to change without notice, Final products & Measurements may vary from this brochure



Imperial Productions®

Imperial Productions & Distribution Inc.

email sales@imperialproductions.com

1-800-399-7585 +1-416-264-6096

copyright 2016 MRDCI All Rights Reserved

NOV-25



Custom Request (Download & Fill-in)

sales@imperialproductions.com IPTUS0914S-TCTB

Name _____

Contact: _____

Phone # _____

Email: _____

Address _____
_____ ZIP/PC _____

FRP-PolyComp™ A Composite Gypsum, Fiberglass, Marble Chips, Prime & Paint by others

(Interior/Exterior)

of Whole Units _____ # of Split Units _____

Type of Split enter Letter _____

Optional Cuts

A

B

C

D



A= Half column

B = 3/4 Outside Corner

C = Wall Cover Engaged

D = 1/4 Column Inside Corner

E = Engaged any percentage

* Possible Limitations due to Quantity Requested and/or Application



Imperial Productions®

1-800-399-7585 +1-416-264-6096

Imperial Productions & Distribution Inc.

email sales@imperialproductions.com copyright 2016 MRDCI All Rights Reserved