

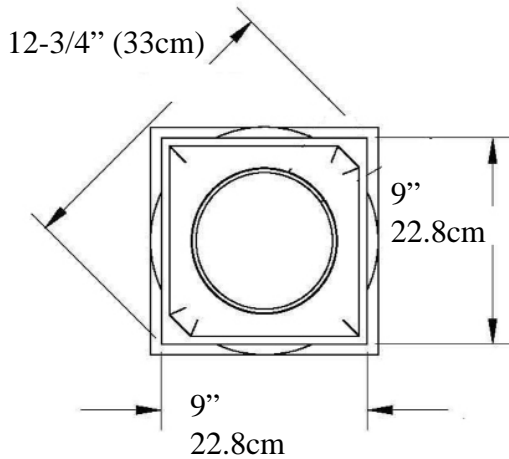

Tuscan Tapered Column

IPTUS0908S-TCTB FiberComp™

Tuscan Capital EconPolymert™



Cap 2-5/8" (6.6cm)=>

Top of Shaft
Minimum
Inside Diameter
5" (12.7cm)

Outside Diameter
6-1/4" (15.8cm)

Tuscan Base EconPolymert™

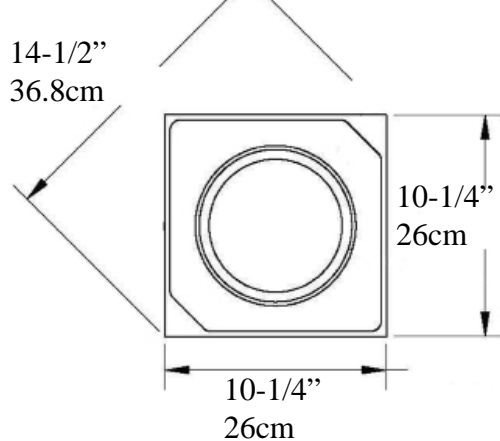

Taper Ends
from Bottom
36"
91.44cm

Optional Cuts

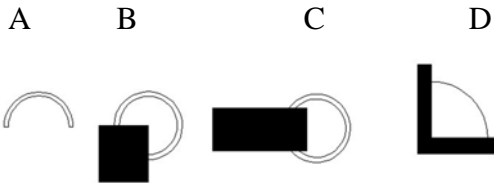

- A= Half column
- B = 3/4 Outside Corner
- C = Wall Cover Engaged
- D = 1/4 Column Inside Corner
- E = Engaged any percentage

Bottom of Column
Outside Diameter
7-5/8"
19.3cm

Base & Plinth
4" (10cm)

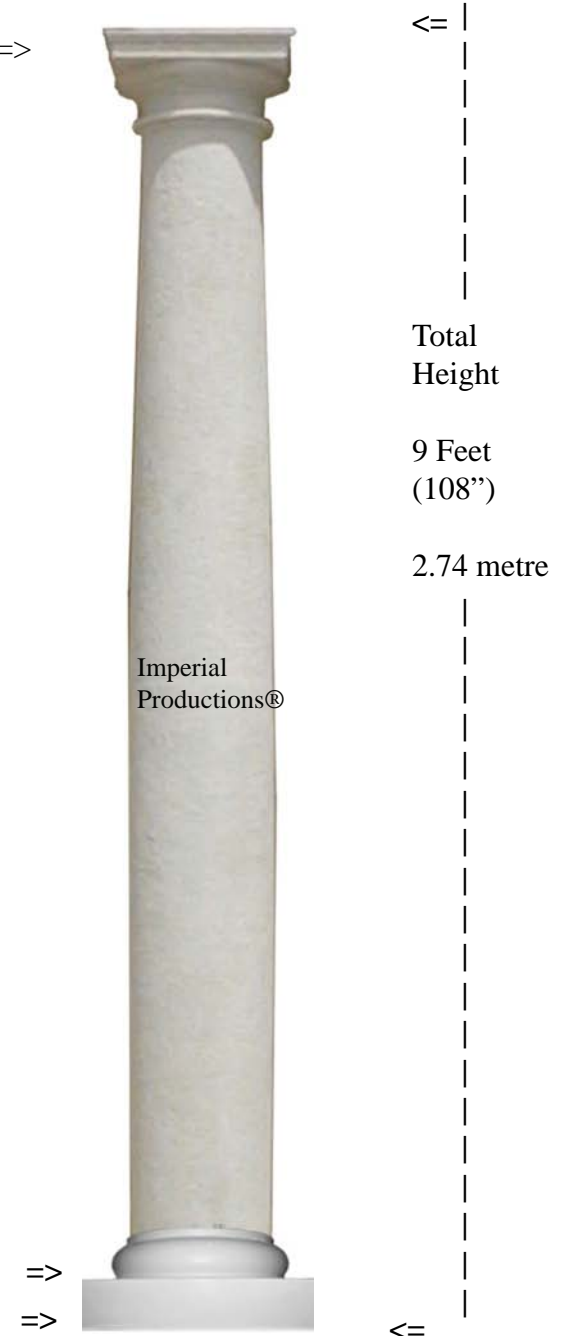

Weight Shaft 66 lb (29.9 Kg)
Center Load Bearing 10,000lbs (4.53m)

* *assembly required, drawing not to scale*

* *For Load Application check with your structural engineer for suitability in your local area*

* All specifications subject to change without notice, Final products & Measurements may vary from this brochure



Imperial Productions®

1-800-399-7585 +1-416-264-6096

Imperial Productions & Distribution Inc

email sales@imperialproductions.com copyright 2016 MRDCI All Rights Reserved



Custom Request (Download & Fill-in)

sales@imperialproductions.com IPTUS0908S-TCTB

Name _____

Contact: _____

Phone # _____

Email: _____

Bill to Address _____
_____ ZIP/PC _____

Ship to Address _____
_____ ZIP/PC _____

All deliveries shipped with insurance

Specify the type of Delivery Required Enter Letter => _____

a) Residential

b) Residential with tailgate

c) Commercial with Loading Dock

d) Commercial Curbside Delivery

A) Whole How Many _____

B) Split for Post Wrap How Many _____

To Wrap Round Post Size _____ Square Post Size _____

How are they split _____

C) Split for Pilaster How Many _____

* Possible Limitations due to Quantity Requested and/or Application



Imperial Productions®

Imperial Productions & Distribution Inc.

email sales@imperialproductions.com copyright 2016 MRDCI All Rights Reserved

1-800-399-7585 +1-416-264-6096