

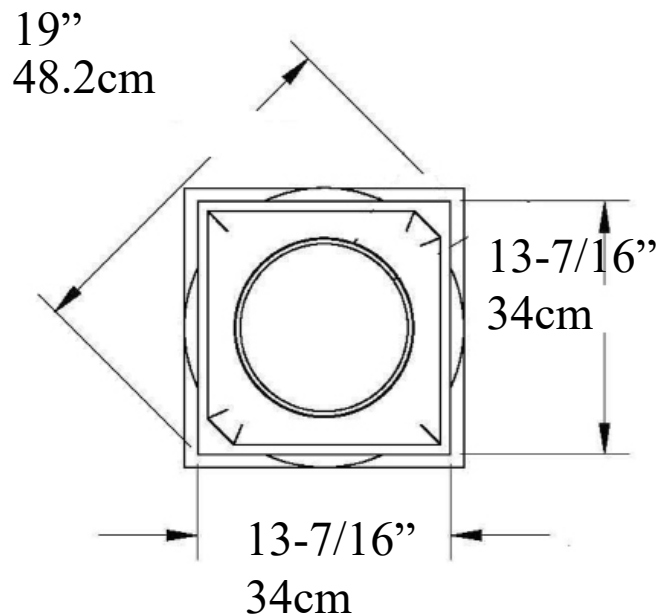

Imperial Productions® Columns

Attic Base IPAB121



Hole 10-3/16" (25.8cm)
Circumference
32 inches

Total Height

5-1/2" (13.9cm)

Top Round: 3-7/8" (9.8cm)

Plinth: 1-5/8" (4.1cm)

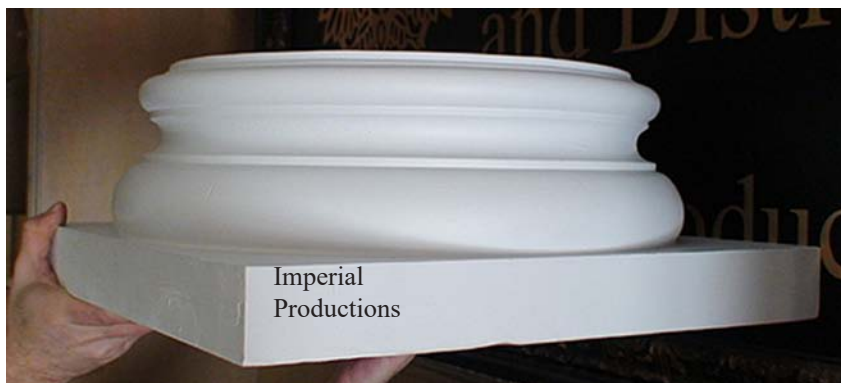

Weight

2 lb

.91 kg

ArchPolymer™ Made from Molds
Interior & Exterior Use
Insect, Rot, Water Resistant
Same Density as White Pine

Other Materials Optional Custom
ArchPolymer Class A Fire Rated
GRG-NeoPlaster™ Interior
GFRC-Zeament™ Exterior

* All specifications subject to change without notice,
Final products & Measurements may vary from this brochure Manufacturing tolerances $\pm 1/8"$ (.31cm)



Imperial Productions®

1-800-399-7585

Imperial Productions & Distribution Inc.

email sales@imperialproductions.com copyright 2016 MRDCI All Rights Reserved

APR-25



Custom Request (Download & Fill-in)

emailto sales@imperialproductions.com

IPAB121

Name _____

Date: _____

Contact: _____



Phone # _____

Email: _____

Address _____
_____ ZIP/PC _____

MATERIAL SELECTION

ArchPolymer™ High Density Polyurethane, Primed ready to paint by Others (Interior/Exterior)

of Unit _____ for Residential

of FireRated Units _____ for Commercial Interior

GRG-NeoPlaster™ A new age plaster, Class A fire rated (Interior)

of Units _____

GFRC-Zeament™ A Concrete Composite (Exterior)

of Units _____

VALUE ADDED FINISHES

Factory Paint Color Code _____ Finish _____

Metal Coated: Type: _____

* Possible Limitations due to Quantity Requested and/or Application



Imperial Productions®

1-800-399-7585

Imperial Productions & Distribution Inc.

email sales@imperialproductions.com copyright 2016 MRDCI All Rights Reserved