

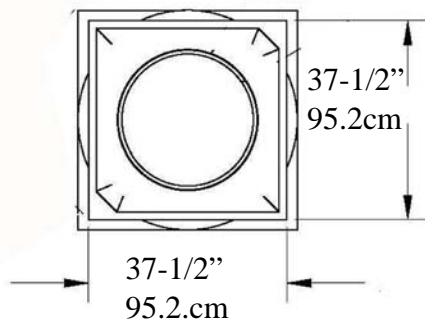

# Doric Tapered IPDOR1830S-FG    Fiberglass

Tuscan Capital ArchPolymert™



Cap 8-5/8" (21.9cm)=>

Top of Shaft

Outside Diameter

27"

68.5cm

Inner Diameter

25" (63.5cm)

<=

Total  
Height

18 Feet  
5.486  
meters

Tuscan Base ArchPolymert™

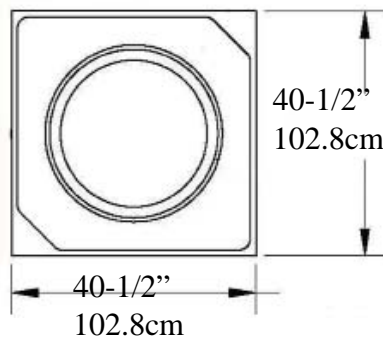

Bottom of Column

Outside Diameter

30"

76.2cm

Imperial  
Productions

## Optional Cuts

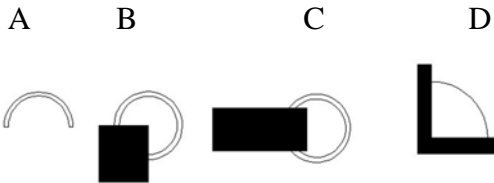

A = Half column

B = 3/4 Outside Corner

C = Wall Cover Engaged

D = 1/4 Column Inside Corner

E = Engaged any percentage

Base & Plinth

16-1/2" (41.9cm)

=>

=>

<=

Weight Shaft 470 lb (213.19 Kg)

Centered Load to 20,000lbs (9.07m tons)

\* assembly required, drawing not to scale      Loads must be Centered on the Shaft

\* Sold as a building Component - Intergration Hardware by others

\* For Load Application check with your structural engineer for suitability in your local area

\* All specifications subject to change without notice, Final products & Measurements may vary from this brochure E/OE



**Imperial Productions®**

Imperial Productions & Distribution Inc

email sales@imperialproductions.com    copyright 2016 MRDCI All Rights Reserved

1-800-399-7585 +1-416-264-6096

SEP-25



# Custom Request (Download & Fill-in)

emailto sales@imperialproductions.com IPDOR1830S

Name \_\_\_\_\_

Contact: \_\_\_\_\_

Phone # \_\_\_\_\_

Email: \_\_\_\_\_

Address \_\_\_\_\_  
\_\_\_\_\_ ZIP/PC \_\_\_\_\_

**FRP-PolyComp™** A Composite Gypsum, Fiberglass, Marble Chips, Prime & Paint by others

(Interior/Exterior)

# of Whole Units \_\_\_\_\_ # of Split Units \_\_\_\_\_

Type of Split enter Letter \_\_\_\_\_

## Optional Cuts

A

B

C

D



A= Half column

B = 3/4 Outside Corner

C = Wall Cover Engaged

D = 1/4 Column Inside Corner

E = Engaged any percentage

\* Possible Limitations due to Quantity Requested and/or Application



**Imperial Productions®**

Imperial Productions & Distribution Inc.

email sales@imperialproductions.com copyright 2016 MRDCI All Rights Reserved

1-800-399-7585 +1-416-264-6096